

# Wrists



## WD Quick Change Wrist

HOSMER

- Permits quick changes of terminal device or its position
- Wrist face is rotated in one direction to allow removal of terminal device
- Rotating in opposite direction will place terminal device in free rotation
- Central position of wrist face locks position of terminal device and will not turn or pull out of wrist
- Standard 1/2-20 thread

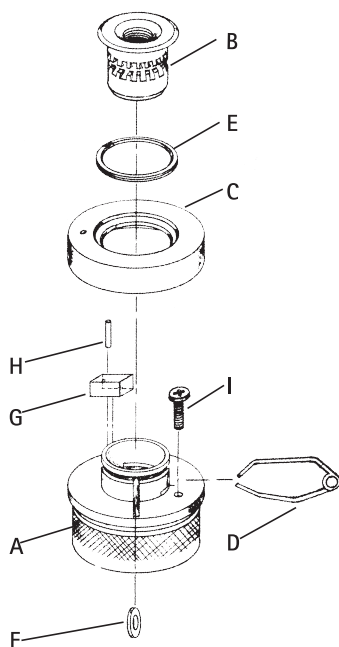

- 52127** WD Quick Change Wrist, *WD-400; Aluminum Insert; 2", (5.1cm) Diameter; 3.75oz (99g)*
- 52128** WD Quick Change Wrist, *WD-400S; Stainless Steel Sleeve And Insert; 4.25oz (120g)*
- 53896** WD Quick Change Wrist, *WD-400SS; All Stainless Steel Wrist And Insert; 7.1oz (201.3g)*

*Includes:*

- A. 52129** Body, *WD-400*  
**52130** Body, *WD-400S*  
**52131** Body, *WD-400SS*
- B. 50527** Insert, *WD-400*  
**50528** Insert, *WD-400S and 400SS*
- C. 52133** Cover Assembly, *WD-400 and 400S*  
**56009** Cover Assembly, *WD-400SS*
- D. 54661** Spring Lock
- E. 52136** Retaining Ring
- F. 52139** Washer
- G. 55510** Felt Oiling Pad
- H. 50873** Roll Pin
- I. 50166** Screw



## UCLA CAPP Delrin Body Friction Wrists

HOSMER

- Constant friction applied with unique friction adjustment collar
- Standard 1/2-20 thread

- 55108** CAPP Wrist 1412, *1-1/2" (3.8cm) Diameter; .75oz (21g)*
- 55109** CAPP Wrist 1413, *1-3/4" (4.4cm) Diameter; 1oz (28g)*
- 55110** CAPP Wrist 1414, *2" (5.1cm) Diameter; 1.5oz (42g)*

*Includes:*

- A. 52805** Housing, *55110*  
**55106** Housing, *55109*  
**55105** Housing, *55108*
- B. 59711** Clamp Assembly
- C. 56661** Socket Head Screw
- 55313** Allen Wrench, *(Not Shown)*

